

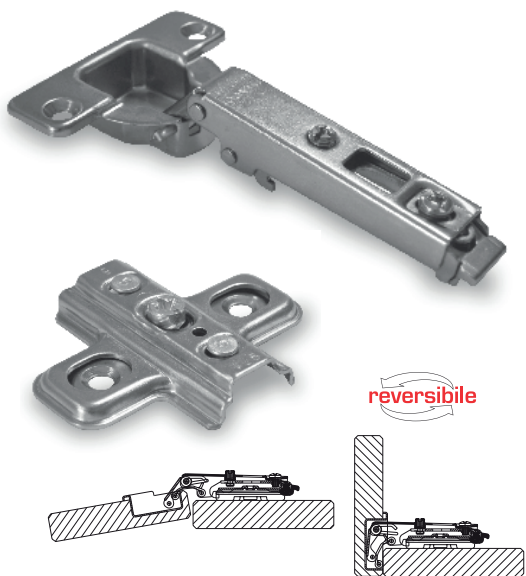

500

Self closing hinges opening 110°



Code: F50080P44

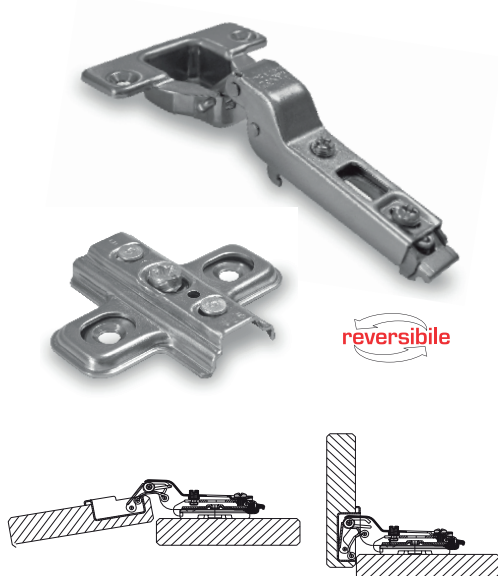

Code: F50080M44

615

Hinges opening 110° Ø 35

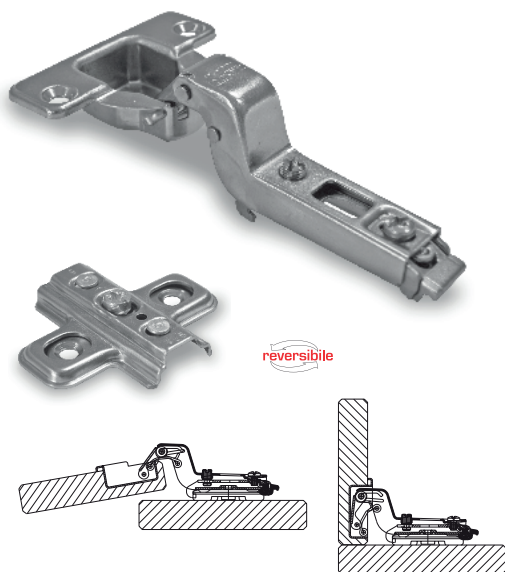

Code: F50080C44

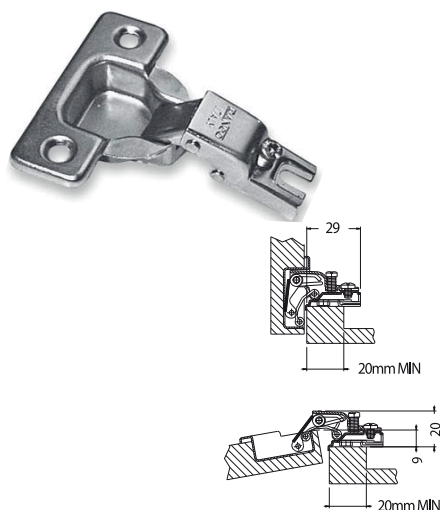

Code: F61670P44

660

Self closing hinges glass door

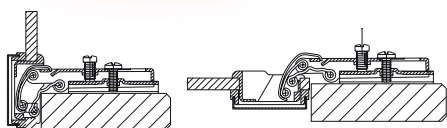
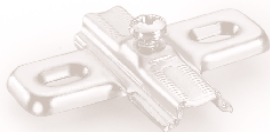
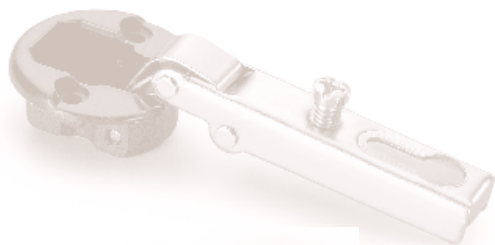

Code: F6602FP14/FZ17-5

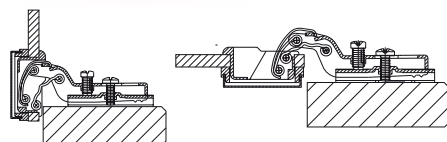
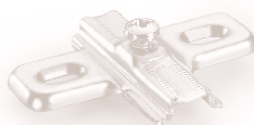

Code: F6602FM14/FZ17-5

780

Self closing hinges opening 90°

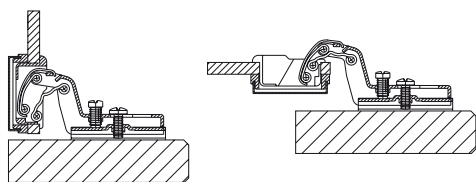
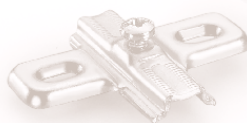
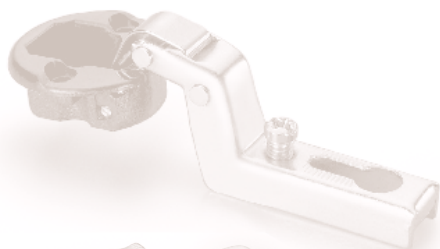

Code: F6602FC14/FZ17-5

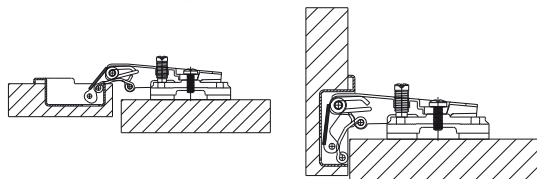
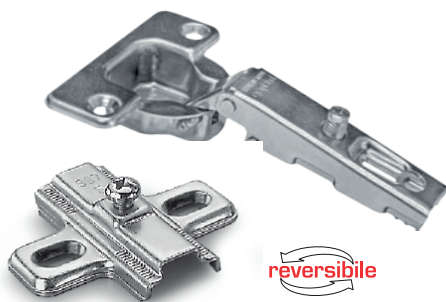

Code: F78060P44

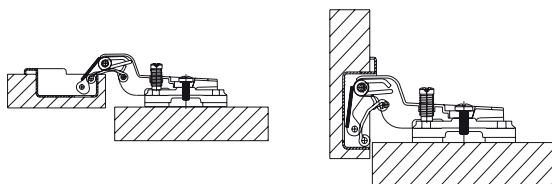
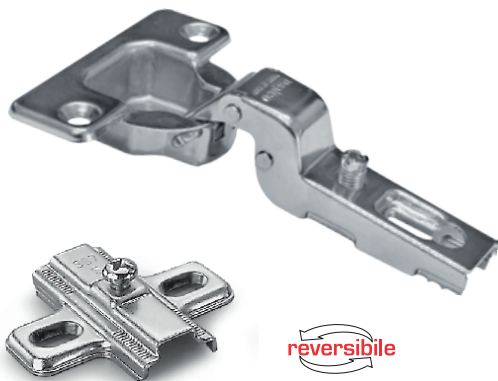

Code: F78060M4

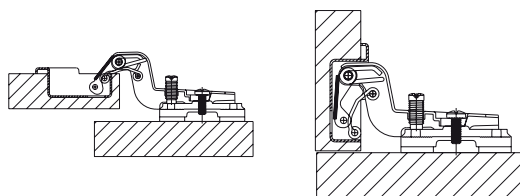
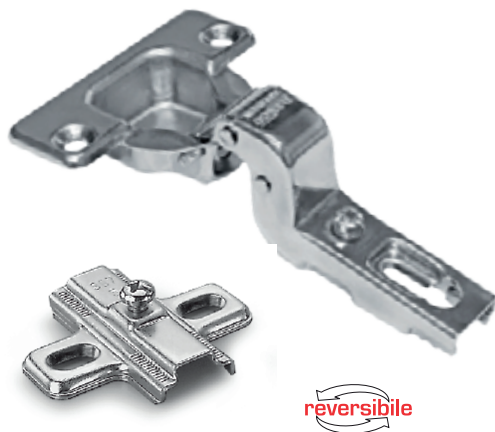

Code: F78060C44

993 Available mounting plates

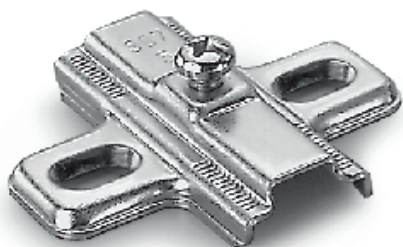

Code: FB993AR/5-4

850 Self closing hinges opening 90°

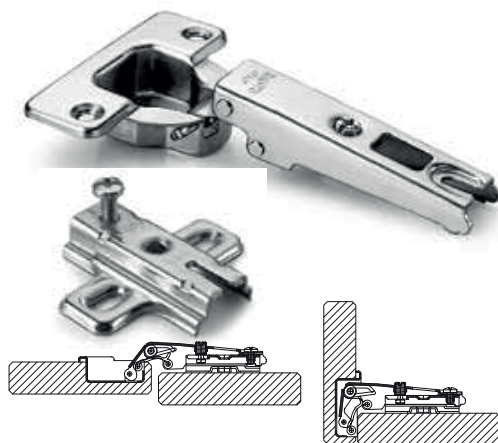

Code: F85070P44

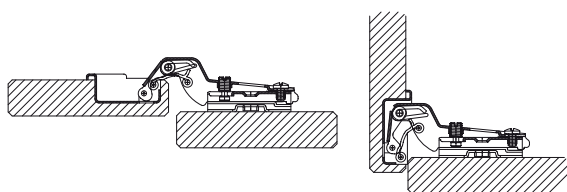

Code: F85070M44

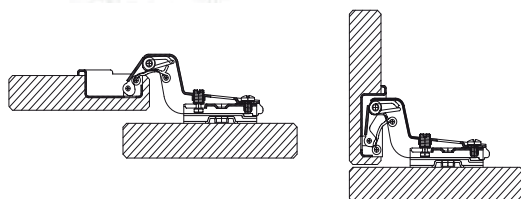

Code: F85070C44

850

Self closing hinges opening 110°

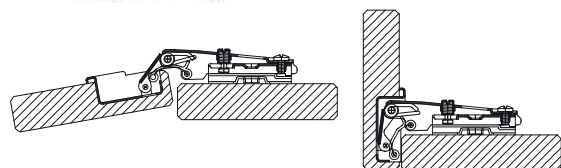

Code: F85080P44P

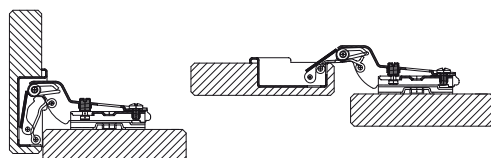

Code: F85090M44

861 Self closing hinges opening 90°

Corners 45°

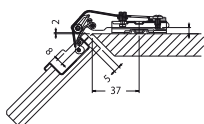
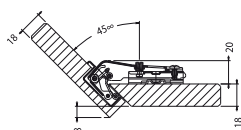

Code: F86160P44

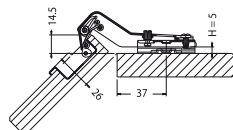
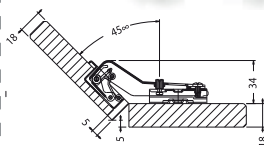

Code: F86160C44

862 Self closing hinges opening 90°

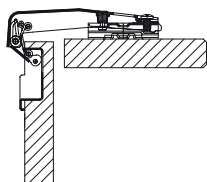
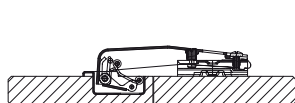

Code: F86260L44

864 Self closing hinges opening 165°

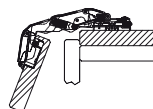
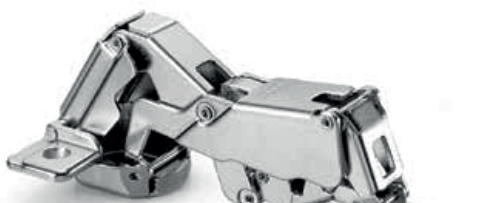

Code: F86401P44

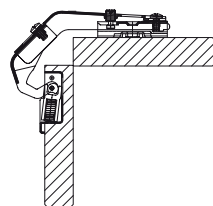
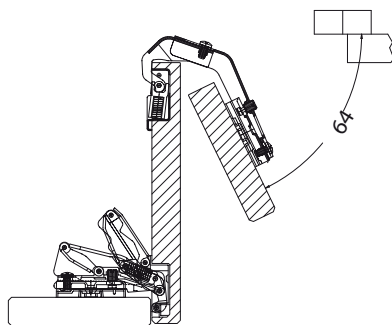

Code: F361ASP44D